

| Type | Product Article | Name | Article | Number | Unit |
|------|-----------------|---------------|---------|--------|------|
| 39 | 3990451 | Foam | 1998830 | 1 | ST |
| | | Nylon | 1008943 | 0.274 | M |
| | | Canvas | 1998716 | 0.134 | LM |
| | | Steel Bar | H000013 | 2 | ST |
| | | Tapping Screw | 1001534 | 10 | ST |
| | | Washer black | 1002994 | 10 | ST |
| 42 | 3990452 | Foam | 1998831 | 1 | ST |
| | | Nylon | 1008943 | 0.28 | M |
| | | Canvas | 1998716 | 0.14 | LM |
| | | Steel Bar | H000013 | 2 | ST |
| | | Tapping Screw | 1001534 | 10 | ST |
| | | Washer black | 1002994 | 10 | ST |
| 44 | 3990453 | Foam | 1998832 | 1 | ST |
| | | Nylon | 1008943 | 0.307 | M |
| | | Canvas | 1998716 | 0.147 | LM |
| | | Steel Bar | H000013 | 2 | ST |
| | | Tapping Screw | 1001534 | 10 | ST |
| | | Washer black | 1002994 | 10 | ST |
| 46 | 3990454 | Foam | 1998833 | 1 | ST |
| | | Nylon | 1008943 | 0.317 | M |
| | | Canvas | 1998716 | 0.154 | LM |
| | | Steel Bar | H000013 | 2 | ST |
| | | Tapping Screw | 1001534 | 10 | ST |
| | | Washer black | 1002994 | 10 | ST |
| 48 | 3990455 | Foam | 1998835 | 1 | ST |
| | | Nylon | 1008943 | 0.327 | M |
| | | Canvas | 1998716 | 0.16 | LM |
| | | Steel Bar | H000013 | 2 | ST |
| | | Tapping Screw | 1001534 | 10 | ST |
| | | Washer black | 1002994 | 10 | ST |
| 50 | 3990456 | Foam | 1998837 | 1 | ST |
| | | Nylon | 1008943 | 0.34 | M |
| | | Canvas | 1998716 | 0.167 | LM |
| | | Steel Bar | H000013 | 2 | ST |
| | | Tapping Screw | 1001534 | 10 | ST |
| | | Washer black | 1002994 | 10 | ST |

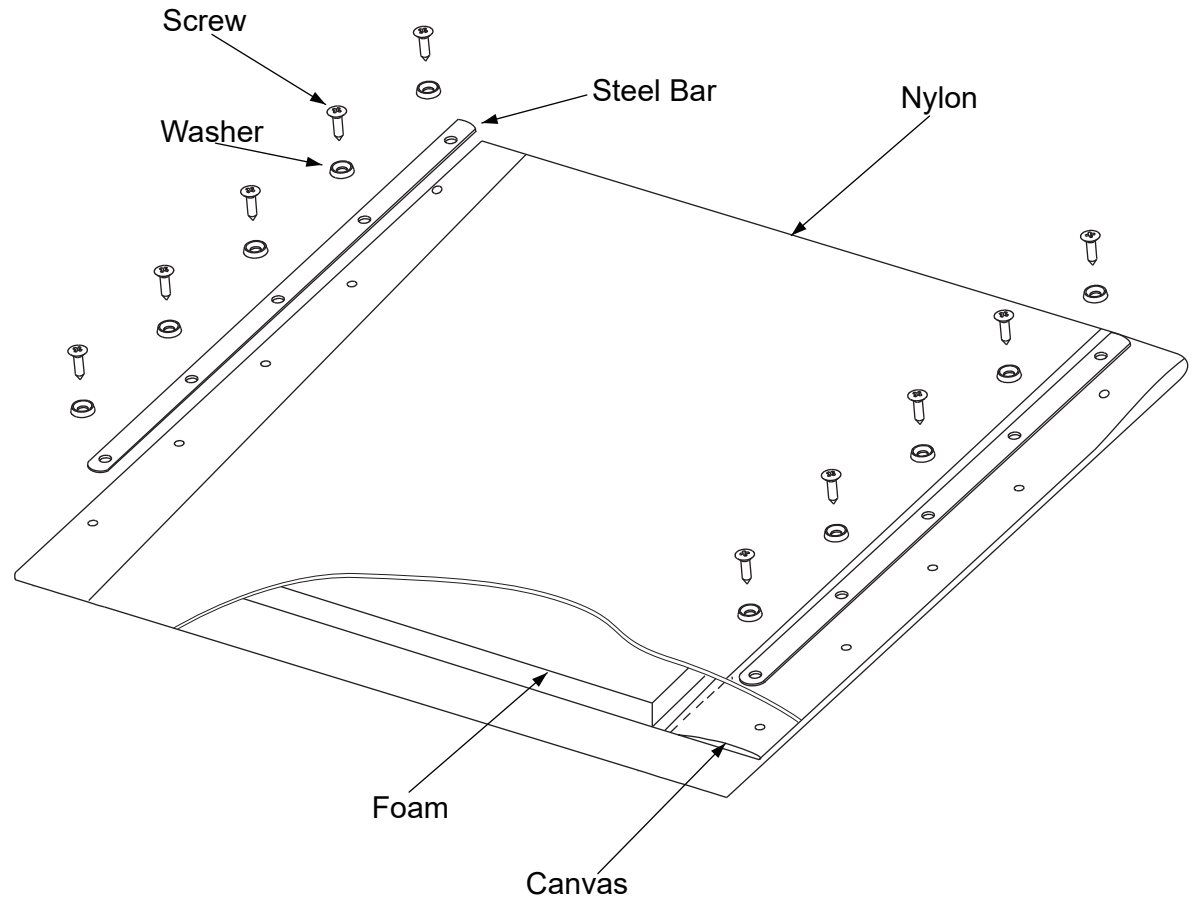

| Tolerance | |
|-----------|------|
| Value | Tol: |
| X>0≤50 | ±0.1 |
| X>50≤100 | ±0.2 |
| X>100≤150 | ±0.3 |
| X>150≤500 | ±0-1 |
| x>500 | ±1 |

3992128

EC00311/B

SEAT JAZZ S50

Plan No.

STEP 1/2

EC00311/B

| | | | | |
|-----|--------------|--------------------|------|-------|
| 3 | | | | |
| 2 | | | | |
| 1 | | | | |
| No. | Requested by | Change description | Date | Init. |

| | | | |
|-----------|------------|------------|------------|
| Scale:1:4 | Drafted | Verified | Confirmed |
| Date | 01/02/2016 | 01/02/2016 | 01/02/2016 |
| Init. | Mars | JJQ | TG |





Cutting the shape of Canvas

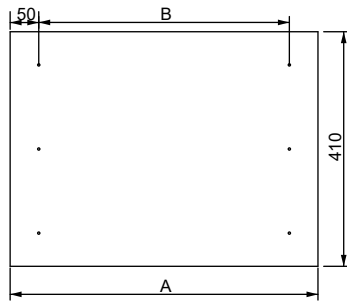

Drilling holes by C525049

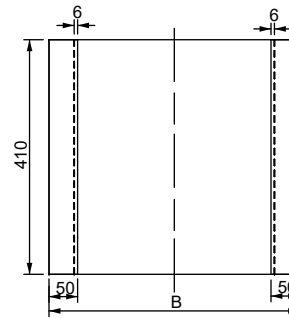

Stitching

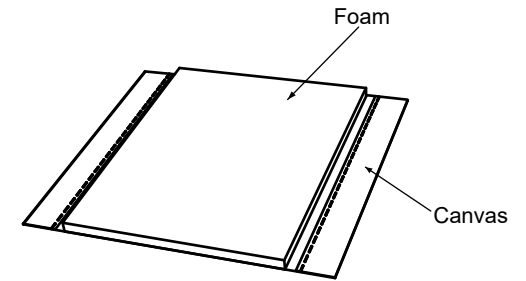

Glue Foam and Canvas use 1999774

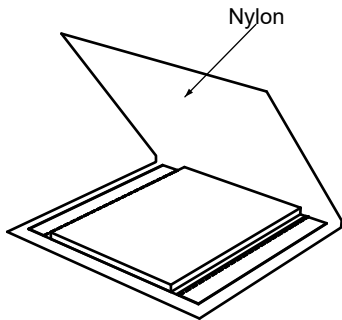

Cover by Nylon

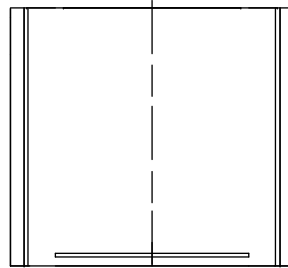

High frequency welding
By matrix: C400242 39#
C400243 42#
C400244 44#
C400245 46#
C400246 48#
C400247 50#

Cut off the excess part along the weld line

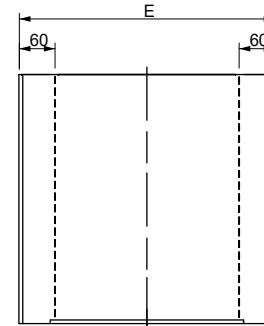

stitching

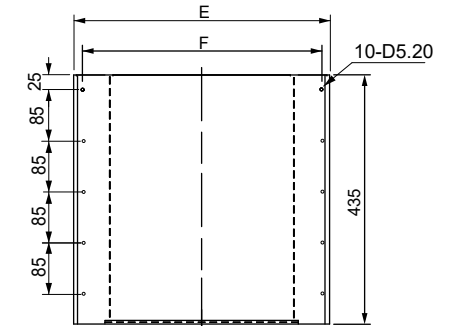

Punching the holes
By C200874

| Type | 39# | 42# | 44# | 46# | 48# | 50# |
|------|-----|-----|-----|-----|-----|-----|
| A | 495 | 525 | 545 | 565 | 585 | 605 |
| B | 395 | 425 | 445 | 465 | 485 | 505 |
| C | 260 | 290 | 310 | 330 | 350 | 370 |
| D | 445 | 475 | 495 | 515 | 535 | 555 |
| E | 400 | 430 | 450 | 470 | 490 | 510 |
| IF | 375 | 405 | 425 | 445 | 465 | 485 |

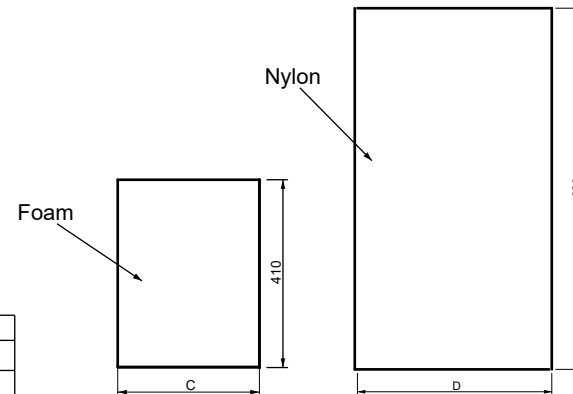

| Tolerance | |
|-----------|------|
| Value | Tol: |
| X>0≤50 | ±0.1 |
| X>50≤100 | ±0.2 |
| X>100≤150 | ±0.3 |
| X>150≤500 | ±0-1 |
| x>500 | ±1 |

EC00311/B

SEAT JAZZ S50

STEP 2/2

Plan No.

EC00311/B

| | | | | |
|-----|--------------|--------------------|----------|-------|
| 3 | | | | |
| 2 | | | | |
| 1 | Betty | Data F updated | 08/06/16 | Betty |
| No. | Requested by | Change description | Date | Init. |

| | | | |
|-----------|------------|------------|------------|
| Scale:1:4 | Drafted | Verified | Confirmed |
| Date | 01/02/2016 | 01/02/2016 | 01/02/2016 |
| Init. | Mars | JJQ | TG |



3992128